

## **Mopeka Pro Water Instructions**

Modified on: Fri, 28 Oct 2022 9:55 AM



### Pro Water Sensor Instructions

#### Smart Device/App Users

1. Go to your app store. Search for Mopeka Tank Check app and install.
2. Launch the app. When it starts it will automatically start a search for Mopeka sensors.
3. Press and hold SYNC button until sensor appears on app. (up to 10 seconds)

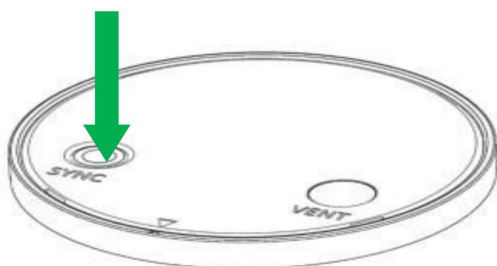

4. The sensor will then appear on your app as a new device.
5. Sensor is now Sync'd. You may now proceed to installing the sensor on the tank.



Mopeka Products LLC  
833-667-3521

M2001001A



Rubber Pad

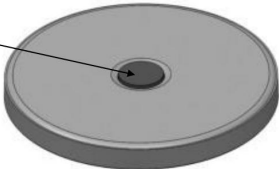

**Install Sensor on Tank**

6. Clean the bottom of the tank of any debris, etc.
7. See graphic below for recommended installation location on bottom of water tank.
8. Now apply provided primer to the area of the tank that will be contacted by the adhesive on the collar. Squeeze the primer tube as shown on primer, to release flow of primer.
9. Peel paper from adhesive on the collar and press the collar firmly on the tank. Press firmly on every collar flange to ensure adhesive makes good contact and is properly activated.
10. Apply a generous amount of the supplied dielectric grease directly to the sensor pad before attaching sensor to the tank.
11. Install sensor into collar with Sync button facing away from tank. Black rubber contact pad should make contact with tank bottom.
12. Install snap ring over the sensor and collar to retain sensor.

Install sensor at least 1 sensor width away from side wall of tank.



Rubber Pad

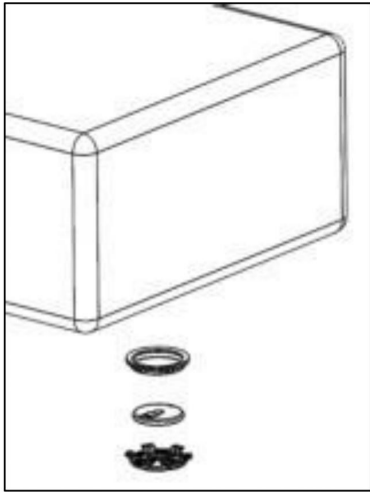

Mopeka Products LLC  
833-667-3521

M2001001A



### Using the App & Sensor App

#### **Users:**

13. Clicking on a sensor in the main list takes you to the sensor's own screen. Most information is self-explanatory. Click on the settings icon (upper right) to change settings or rename your sensor.
14. Be sure to go to the tank size setting and enter the overall height of the water tank.

### **BATTERY CHANGE INSTRUCTIONS**

#### **WARNING**

EXPLOSION HAZARD-BATTERIES MUST ONLY BE CHANGED IN AN AREA FREE OF IGNITIBLE CONCENTRATIONS.

1. The enclosure lid is held in place by a snap fit, in 4 places. In the locations shown, insert small screwdriver, knife, or similar into gap between lid and base and pry outward to release snap fit. Lid can then be lifted out of assembly.

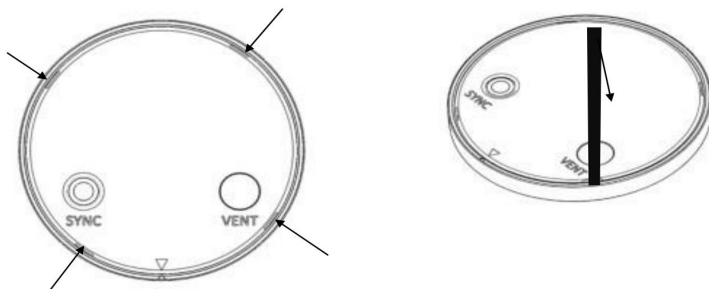

2. Pry battery so that it is released from plastic and battery contacts lips that hold it in position.
3. Place new battery, positive side up.
4. Position lid so that alignment marks meet, and then press at each snap fit slot until snap reengages. It may take a firm press to get the snaps reengaged.

Mopeka Products LLC  
833-667-3521

M2001001A

ProWater Instructions MopekaIOT  
Website.10.24.22.pdf  
(231.01 KB)